

KEY PLAN

SUITE QUANTITY: 1 PER FLOOR
APPLICABLE FLR: 2ND THRU 4TH
TOTAL SUITE QUANTITY: 3

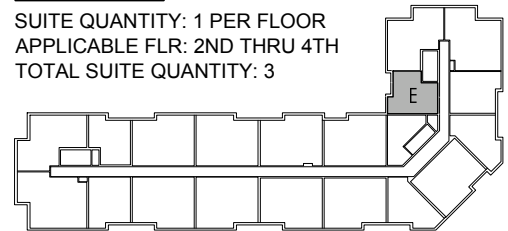

GRYPHON



Plan and Specifications subject to change without notice.
E. & O.E. Actual floor space may vary from the stated floor area.

SUITE E

SUITE AREA: 660 SF
BALCONY AREA: 73 SF
TOTAL LIVING: 733 SF